

Mounted filter data sheet LPF-λ-5x5-12.7g-c

Filter chip area	5 mm x 5 mm
Filter chip thickness	625 μm
Chip material	semi-insulating GaAs

The filter chip is glued on a gold-plated copper ring with 12.7 mm outer diameter and a 4 mm Ø center hole using a thermal conducting paste.

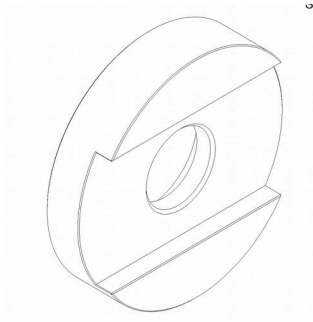

Mount: gold-plated copper ring with: 12.7 mm outer diameter
4 mm diameter center hole
3 mm thickness

